

# Windows Stocking

Designed by Katie Frym

A Fat Quarter friendly project 😊

Through the Woods fabric  
By Maywood Studio &  
Kris Lammers



*Maywood*  
S T U D I O

6000 N. Cutter Cir.  
4561 Maywood Ave

Portland, OR 97217  
Vernon, CA 90058

800.433.0722  
800.237.6620

503.284.4124  
323.584.8820

# Windows Stocking

Designed by Katie Frym, Maywood Studio  
Instructions by Jackie Robinson, Animas Quilts  
830 Douglas Hill Road  
Eureka, MT 59917  
www.animas.com

## Fabric

Yardage - All Fat Quarters

Center Squares - 1664-R

Logs - 1668-R

Heel, Toe & Cuff - 1669-J

Cuff - 1667-R

Backing - 1665-R

Lining - 1663-R and 1669-R

## Cutting

Center Squares

Cut (9) 2-1/2" squares, on point,  
centering snowman head

Logs

Cut (1) 4-1/2" x 20" strip into:

(1) 4-1/2" square

(1) 4-1/2" x 2"

(2) 3" x 2-1/2"

(3) 2" squares

Cut (7) 1-1/2" x 20" strips into:

(18) 1-1/2" x 4-1/2"

(18) 1-1/2" x 2-1/2"

Heel, Toe & Cuff

Cut (1) 8-1/2" x 20" strip into:

(1) 8-1/2" x 3-1/2"

(8) 8-1/2" x 1-1/2"

Cut (1) 2" x 5-1/2"

Cuff

Cut (1) 8-1/2" x 20" strip into:

(8) 8-1/2" x 1-1/2"

(1) 1-1/2" x 5-1/2"

Backing

Cut (1) 13" x 21"

Lining

Cut from Two Fat Quarters

(2) 13" x 21"

## Construction

An accurate 1/4" seam allowance is imperative. Take time to do a seam allowance check before beginning. Cut TWO pieces of fabric exactly 1-1/2" x 4". Stitch them together with a 1/4" seam. Press in either direction. At the midpoint along this unit, measure across. It should be 2-1/2". If not, adjust your seam and repeat until you are correct.

This stocking finishes 8" wide. The piecing, when accurate, will allow you to place the pattern on, nearly exactly. Should your piece be too small because of large seams you may either add a small strip along the edge OR trim the stocking pattern a wee bit to make it fit,

The Stocking shaped pattern is available full size as a separate download named Stocking Template.

1. Stitch a 1-1/2" x 2-1/2" Log to two opposite sides of each 2-1/2" Center Square. Make (9). Do NOT press; though direct the seams toward the Logs.



2. Add the 1-1/2" x 4-1/2" Logs to the remaining two sides of each Step 1 unit. Make (9) which measure 4-1/2" square from raw edge to raw edge. Press toward the Logs.

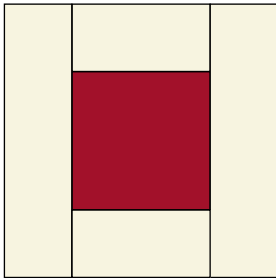

3. Use the Step 2 units and the (1) 4-1/2" square of Log, (1) 4-1/2" x 2" of Log, (2) 3" x 2-1/2" of Log, (3) 2" squares of Log, the 8-1/2" x 3-1/2" of Heel and the 2" x 5-1/2" of Heel to lay out the Stocking Front patchwork. Stitch it together, taking care to maintain accuracy. Alternate the seams. Press carefully – very flat. The narrow part should be 8-1/2" wide, raw edge to raw edge. The vertical measurement is 20-1/2" raw edge to raw edge.

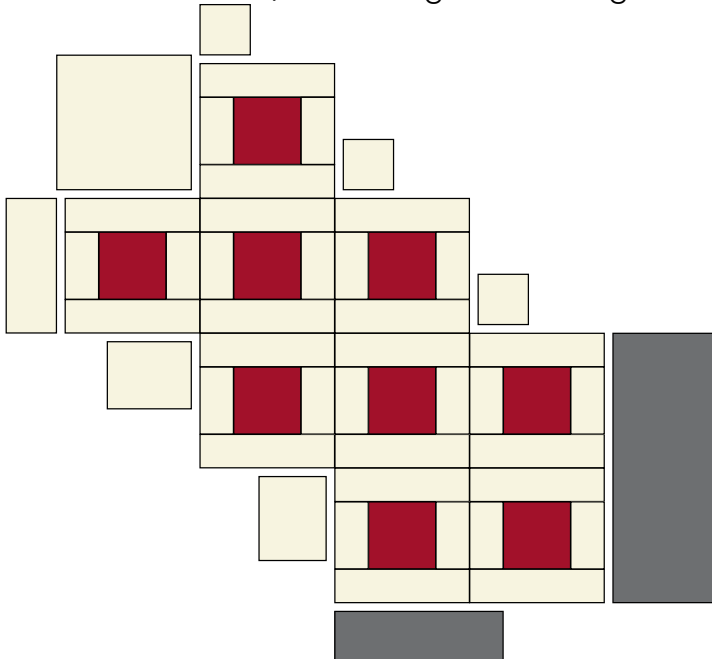

4. Position the Stocking pattern on the patchwork and cut the shape.

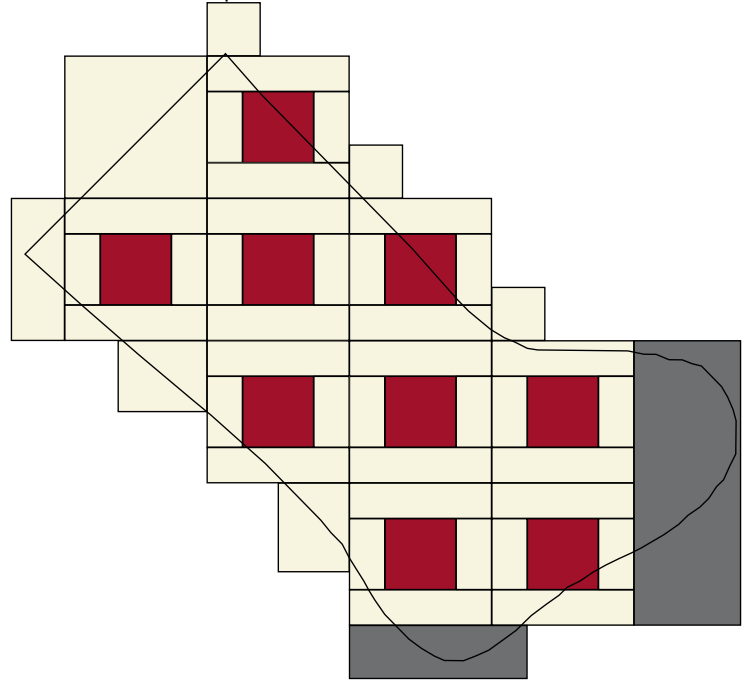

5. Place the Stocking pattern upside down on the right side of the 13" x 21" Backing. Cut a Stocking back in mirror image to the front.

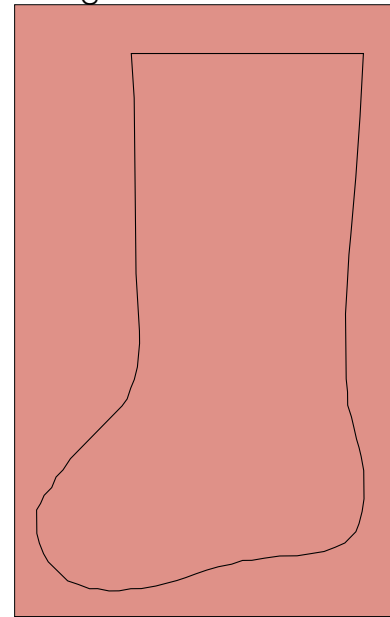

6. In the same manner cut (2) mirror image Stocking patterns from the (2) 13" x 21" Lining pieces.

7. Right sides together, stitch the Stocking front and back together, leaving open at the upper edge. Clip the seams to the stitching line carefully in the curved areas. Turn right side out and finger press.

8. Right sides together, stitch the Lining front and back together, except . . . along the long 'back' seam, stitch about 4" from the top. Leave 6" 'open' for turning later. Continue stitching around the heel, toe and back to the top. Leave this piece inside out.

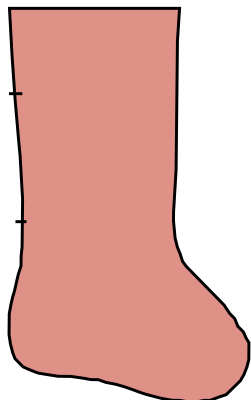

9. Stitch the 8-1/2" x 1-1/2" Cuff pieces together, alternately. Press nice and flat. It will measure 16-1/2" x 8-1/2".

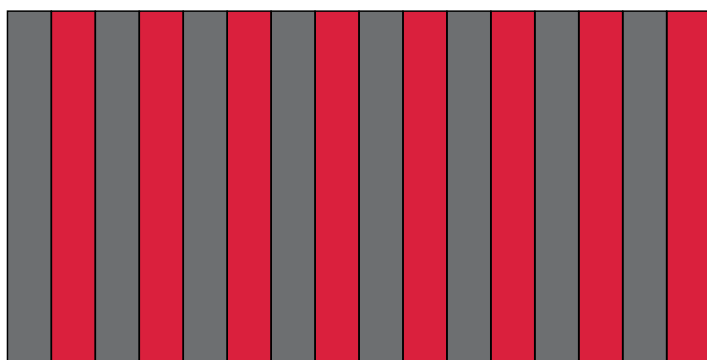

10. Place the cuff side seams together, right sides together, and stitch the cuff into a tube. Press this seam open. Turn right side out, and fold it in half. It will be a 16" x 4-1/2" tube with a facing. The upper edge will be open.

11. Slide the Step 10 cuff over the outside of the right side out stocking. Pin in place with the upper raw edges even.

12. Make a loop to hang the stocking from the 1-1/2" x 5-1/2" Cuff fabric. Fold both long edges toward the center, then fold that in half and stitch along the edge. Make certain it is right side out when stitched.

13. Fold the Step 12 loop in half. Match the raw edges to the raw edges of the top of the Stocking and pin in place.

14. Gently stuff the Step 11 Stocking inside the wrong side out Lining. Match the upper raw edges, taking care to have the toe heading the same direction on both pieces. Pin. Stitch around the upper edge.

15. Carefully pull the Stocking through the 6" opening you left in the Lining. Close the Lining opening by folding the seams to the inside, matching the folds, and stitching very close to the folded seams.

16. Stuff the Lining into the stocking. Shape the Cuff so it stands tall and folds only barely over the top of the Stocking, exposing the loop.

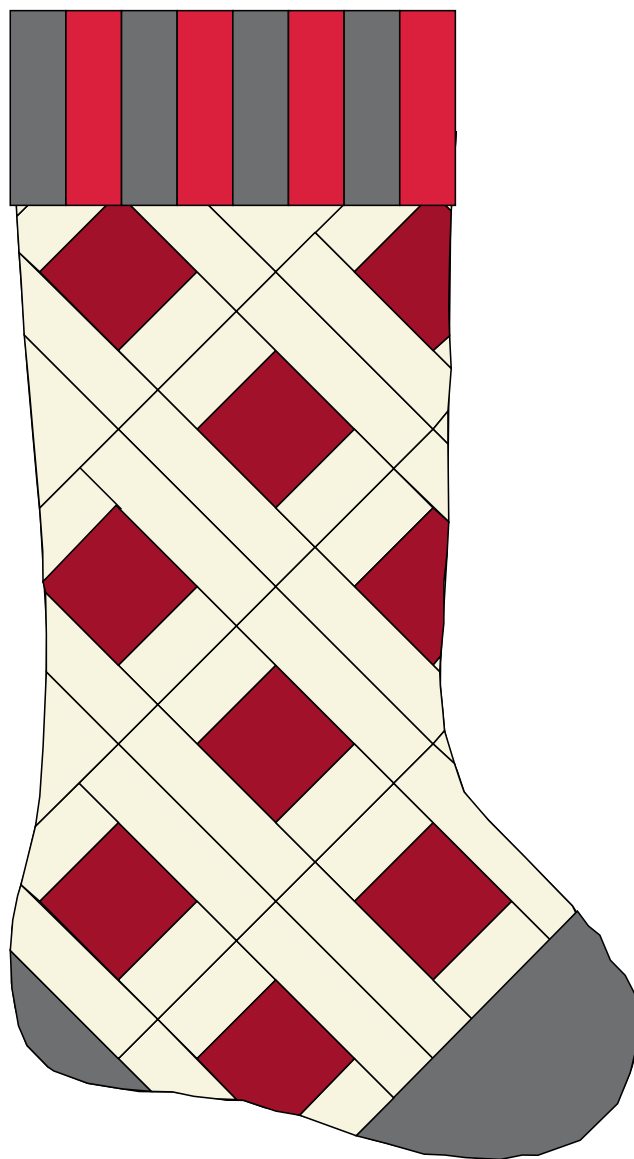

17. Embellish the Stocking, Cuff, or both.

Enjoy.

Stocking Template 50% of actual size. Print or copy at 200% to get actual size.  
A full size template is available as a separate download named Stocking Template2

